



# ELECTION POLLING

CITYOFPSL.COM/CODECOMPLIANCE

POLLING LOCATION EXAMPLE:  
PORT ST. LUCIE COMMUNITY CENTER

DURING EARLY VOTING PERIOD & ELECTION DAY

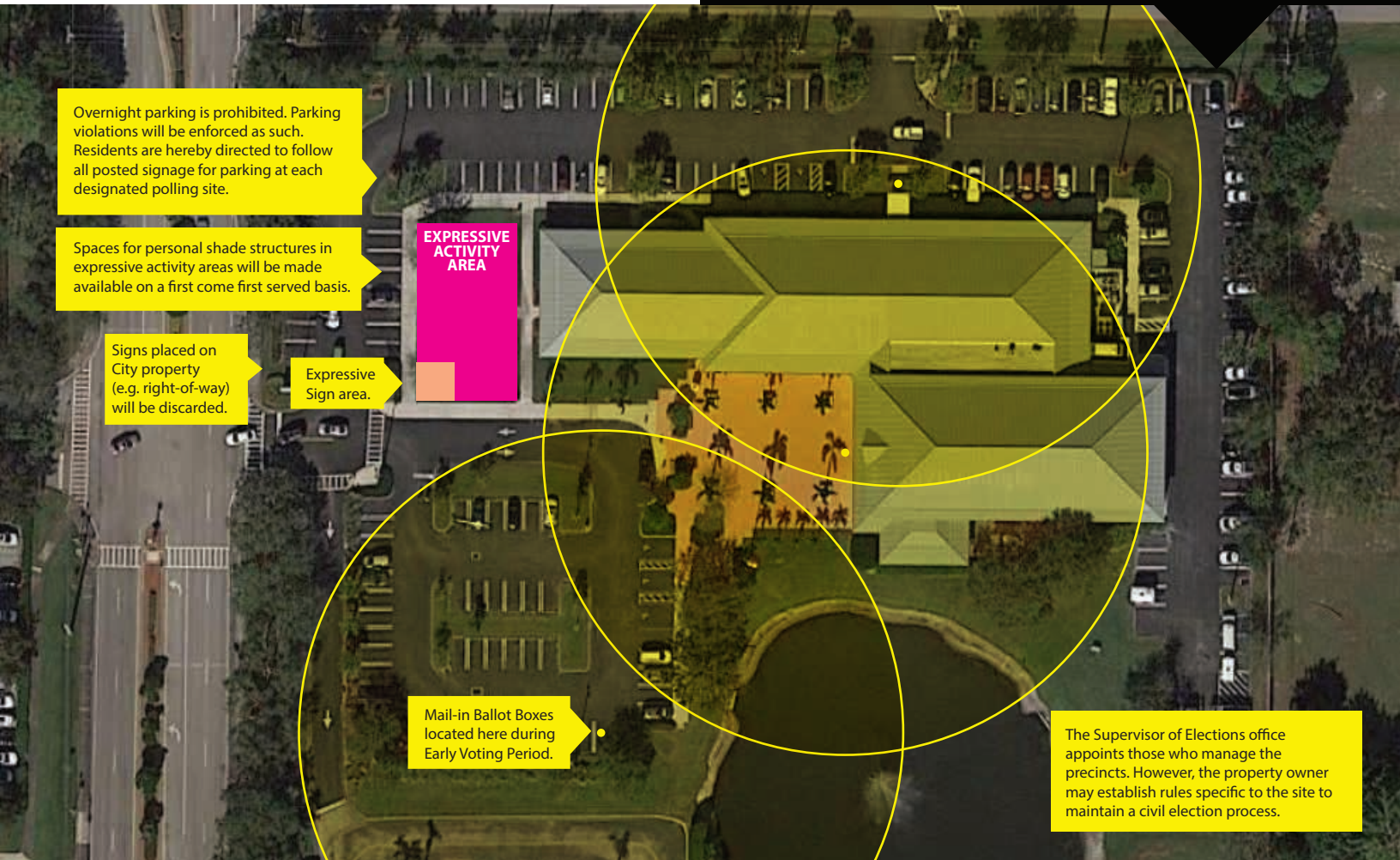

## SIGNS

- Signs are permitted to be placed in the ground on City property only within the marked Expressive Sign Area. Any sign placed in the Expressive Sign Area must not exceed 4 square feet, must be less than 36 inches in height, and may only be a standard h-frame yard sign.
- The City prohibits signs placed in the right-of-way of any street or roadway. The "right-of-way" is the area directly parallel to a road or street pavement edge and the property line of the adjacent property. Signs placed in the right-of-way will be removed and discarded by City staff as trash/litter.
- Citizens may hold signs by hand in the right-of-way, however at no time may the sign holder or sign create a traffic hazard. Sign holding may not interfere with or obstruct free and clear vision for pedestrians or vehicle movement.

## VEHICLES

- Overnight parking is prohibited. Parking violations will be enforced as such. Residents are hereby directed to follow all posted signage for parking at each designated polling site.
- Per City Ordinance Sec. 155.05(K): Signs are prohibited from being placed on trailers.
- Per City Ordinance Sec. 155.05(O): Any sign which extends from, attaches to, or adds to the original body of a vehicle is prohibited.

## SHADE STRUCTURES

- Spaces for personal shade structures in expressive activity areas are available on a first come first served basis. Each user will be allotted one 13x13 foot plot in order to accommodate personal shade structures that do not exceed 10x10 feet.
- Shade structures may be erected during Early Voting periods, Primary Election day, and General Election day from 6 AM until 7 p.m. For safety and security reasons, shade structures must be removed each evening and taken off the property.
- Shade structures are prohibited from being staked into the ground to prevent pipeline and irrigation issues. Sandbags and other weighted materials that do not penetrate the ground are allowed.
- Personal shade structure users must follow posted "Rules for Use" established by the City. This includes social distancing requirements set forth by the facility.
- Equipment requiring electrical hook ups and portable generators are strictly prohibited.
- The Supervisor of Elections is authorized to use shade structures at City-owned polling sites when necessary and only for the performance of his or her public duties.

## NO SOLICITATION ZONES

- No person shall solicit within 150 feet of an entrance to any polling place. See graphic above for areas of no solicitation which are circled in yellow.
- As a result of Senate Bill 90, revisions were made to expand the 150 feet no-solicitation zone to include the area around all Secure Ballot Drop Boxes.

## City-owned Voting Sites

MIDFLORIDA Credit Union Event Center, 9221 SE Event Center Place

City of Port St. Lucie Community Center, 2195 SE Airoso Blvd.

Robert E. Minsky Gym, 750 SW Darwin Blvd.

For a full list of voting sites in Port St. Lucie, visit [slcelections.com](http://slcelections.com).





# ELECTION POLLING

CITYOFPSL.COM/CODECOMPLIANCE

## POLLING LOCATION EXAMPLE: ROBERT E. MINSKY GYM

**DURING EARLY VOTING PERIOD & ELECTION DAY**



## SIGNS

- Signs are permitted to be placed in the ground on City property only within the marked Expressive Sign Area. Any sign placed in the Expressive Sign Area must not exceed 4 square feet, must be less than 36 inches in height, and may only be a standard h-frame yard sign.
- The City prohibits signs placed in the right-of-way of any street or roadway. The "right-of-way" is the area directly parallel to a road or street pavement edge and the property line of the adjacent property. Signs placed in the right-of-way will be removed and discarded by City staff as trash/litter.
- Citizens may hold signs by hand in the right-of-way, however at no time may the sign holder or sign create a traffic hazard. Sign holding may not interfere with or obstruct free and clear vision for pedestrians or vehicle movement.

## VEHICLES

- Overnight parking is prohibited. Parking violations will be enforced as such. Residents are hereby directed to follow all posted signage for parking at each designated polling site.
- Per City Ordinance Sec. 155.05(K): Signs are prohibited from being placed on trailers.
- Per City Ordinance Sec. 155.05(O): Any sign which extends from, attaches to, or adds to the original body of a vehicle is prohibited.

## SHADE STRUCTURES

- Spaces for personal shade structures in expressive activity areas are available on a first come first served basis. Each user will be allotted one 13x13 foot plot in order to accommodate personal shade structures that do not exceed 10x10 feet.
- Shade structures may be erected during Early Voting periods, Primary Election day, and General Election day from 6 AM until 7 p.m. For safety and security reasons, shade structures must be removed each evening and taken off the property.
- Shade structures are prohibited from being staked into the ground to prevent pipeline and irrigation issues. Sandbags and other weighted materials that do not penetrate the ground are allowed.
- Personal shade structure users must follow posted "Rules for Use" established by the City. This includes social distancing requirements set forth by the facility.
- Equipment requiring electrical hook ups and portable generators are strictly prohibited.
- The Supervisor of Elections is authorized to use shade structures at City-owned polling sites when necessary and only for the performance of his or her public duties.

## NO SOLICITATION ZONES

- No person shall solicit within 150 feet of an entrance to any polling place. See graphic above for areas of no solicitation which are circled in yellow.
- As a result of Senate Bill 90, revisions were made to expand the 150 feet no-solicitation zone to include the area around all Secure Ballot Drop Boxes.

### City-owned Voting Sites

MIDFLORIDA Credit Union Event Center, 9221 SE Event Center Place  
City of Port St. Lucie Community Center, 2195 SE Airosa Blvd.

Robert E. Minsky Gym, 750 SW Darwin Blvd.

For a full list of voting sites in Port St. Lucie, visit [slcelections.com](http://slcelections.com).





# ELECTION POLLING

CITYOFPSL.COM/CODECOMPLIANCE

**POLLING LOCATION EXAMPLE:  
MIDFLORIDA CREDIT UNION EVENT CENTER**

**DURING EARLY VOTING PERIOD AND ELECTION DAY**

Overnight parking is prohibited. Parking violations will be enforced as such. Residents are hereby directed to follow all posted signage for parking at each designated polling site.

Signs placed on City property (e.g. right-of-way) will be discarded.

Expressive sign area.

Spaces for personal shade structures in expressive activity areas will be made available on a first come first served basis.

**EXPRESSIVE ACTIVITY AREA**

Mail-in Ballot Boxes located here during Early Voting Period.

The Supervisor of Elections office appoints those who manage the precincts. However, the property owner may establish rules specific to the site to maintain a civil election process.

## SIGNS

- Signs are permitted to be placed in the ground on City property only within the marked Expressive Sign Area. Any sign placed in the Expressive Sign Area must not exceed 4 square feet, must be less than 36 inches in height, and may only be a standard h-frame yard sign.
- The City prohibits signs placed in the right-of-way of any street or roadway. The "right-of-way" is the area directly parallel to a road or street pavement edge and the property line of the adjacent property. Signs placed in the right-of-way will be removed and discarded by City staff as trash/litter.
- Citizens may hold signs by hand in the right-of-way, however at no time may the sign holder or sign create a traffic hazard. Sign holding may not interfere with or obstruct free and clear vision for pedestrians or vehicle movement.

## VEHICLES

- Overnight parking is prohibited. Parking violations will be enforced as such. Residents are hereby directed to follow all posted signage for parking at each designated polling site.
- Per City Ordinance Sec. 155.05(K): Signs are prohibited from being placed on trailers.
- Per City Ordinance Sec. 155.05(O): Any sign which extends from, attaches to, or adds to the original body of a vehicle is prohibited.

## SHADE STRUCTURES

- Spaces for personal shade structures in expressive activity areas are available on a first come first served basis. Each user will be allotted one 13x13 foot plot in order to accommodate personal shade structures that do not exceed 10x10 feet.
- Shade structures may be erected during Early Voting periods, Primary Election day, and General Election day from 6 AM until 7 p.m. For safety and security reasons, shade structures must be removed each evening and taken off the property.
- Shade structures are prohibited from being staked into the ground to prevent pipeline and irrigation issues. Sandbags and other weighted materials that do not penetrate the ground are allowed.
- Personal shade structure users must follow posted "Rules for Use" established by the City. This includes social distancing requirements set forth by the facility.
- Equipment requiring electrical hook ups and portable generators are strictly prohibited.
- The Supervisor of Elections is authorized to use shade structures at City-owned polling sites when necessary and only for the performance of his or her public duties.

## NO SOLICITATION ZONES

- No person shall solicit within 150 feet of an entrance to any polling place. See graphic above for areas of no solicitation which are circled in yellow.
- As a result of Senate Bill 90, revisions were made to expand the 150 feet no-solicitation zone to include the area around all Secure Ballot Drop Boxes.

### City-owned Voting Sites

MIDFLORIDA Credit Union Event Center, 9221 SE Event Center Place

City of Port St. Lucie Community Center, 2195 SE Airoso Blvd.

Robert E. Minsky Gym, 750 SW Darwin Blvd.

For a full list of voting sites in Port St. Lucie, visit [slcelections.com](http://slcelections.com).



# ELECTION POLLING

CITYOFPSL.COM/CODECOMPLIANCE

**POLLING LOCATION EXAMPLE:  
MIDFLORIDA CREDIT UNION EVENT CENTER**

**ALTERNATIVE BALLOT BOX & EXPRESSIVE ACTIVITY AREA  
LOCATION DURING SCHEDULED OUTDOOR EVENTS**

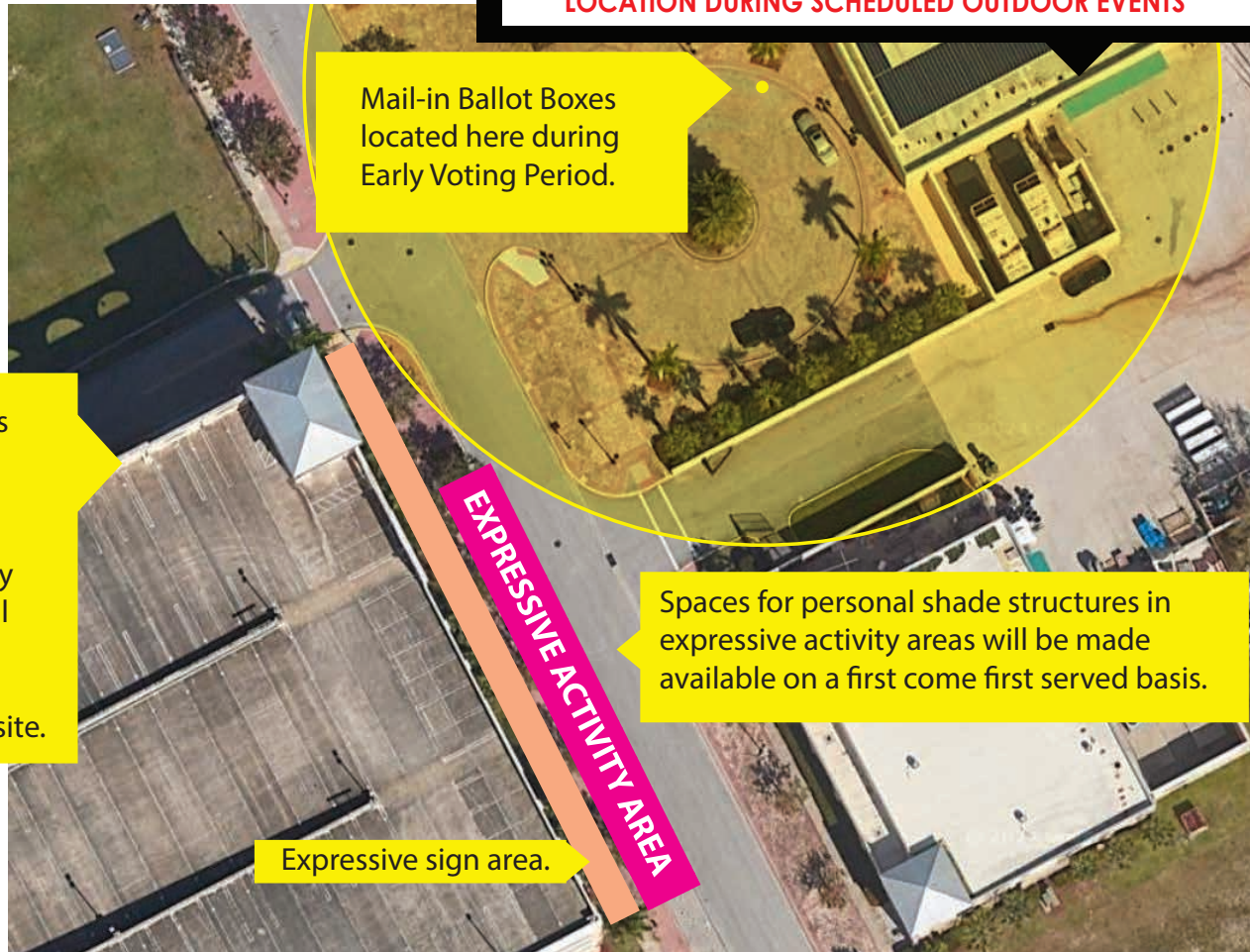

## SIGNS

- Signs are permitted to be placed in the ground on City property only within the marked Expressive Sign Area. Any sign placed in the Expressive Sign Area must not exceed 4 square feet, must be less than 36 inches in height, and may only be a standard h-frame yard sign.
- The City prohibits signs placed in the right-of-way of any street or roadway. The "right-of-way" is the area directly parallel to a road or street pavement edge and the property line of the adjacent property. Signs placed in the right-of-way will be removed and discarded by City staff as trash/litter.
- Citizens may hold signs by hand in the right-of-way, however at no time may the sign holder or sign create a traffic hazard. Sign holding may not interfere with or obstruct free and clear vision for pedestrians or vehicle movement.

## VEHICLES

- Overnight parking is prohibited. Parking violations will be enforced as such. Residents are hereby directed to follow all posted signage for parking at each designated polling site.
- Per City Ordinance Sec. 155.05(K): Signs are prohibited from being placed on trailers.
- Per City Ordinance Sec. 155.05(O): Any sign which extends from, attaches to, or adds to the original body of a vehicle is prohibited.

## SHADE STRUCTURES

- Spaces for personal shade structures in expressive activity areas are available on a first come first served basis. Each user will be allotted one 13x13 foot plot in order to accommodate personal shade structures that do not exceed 10x10 feet.
- Shade structures may be erected during Early Voting periods, Primary Election day, and General Election day from 6 AM until 7 p.m. For safety and security reasons, shade structures must be removed each evening and taken off the property.
- Shade structures are prohibited from being staked into the ground to prevent pipeline and irrigation issues. Sandbags and other weighted materials that do not penetrate the ground are allowed.
- Personal shade structure users must follow posted "Rules for Use" established by the City. This includes social distancing requirements set forth by the facility.
- Equipment requiring electrical hook ups and portable generators are strictly prohibited.
- The Supervisor of Elections is authorized to use shade structures at City-owned polling sites when necessary and only for the performance of his or her public duties.

## NO SOLICITATION ZONES

- No person shall solicit within 150 feet of an entrance to any polling place. See graphic above for areas of no solicitation which are circled in yellow.
- As a result of Senate Bill 90, revisions were made to expand the 150 feet no-solicitation zone to include the area around all Secure Ballot Drop Boxes.

### City-owned Voting Sites

MIDFLORIDA Credit Union Event Center, 9221 SE Event Center Place  
City of Port St. Lucie Community Center, 2195 SE Airoso Blvd.  
Robert E. Minsky Gym, 750 SW Darwin Blvd.

For a full list of voting sites in Port St. Lucie, visit [slcelections.com](http://slcelections.com).